



PWM5 PRO



USER MANUAL

Item name	PWM5-Pro
Ordering code	LBD-PWM5PRO-CAS
Item code	LBD-PWM5PRO-CAS
Date	10-Jan-2025

PWM5 Pro - Constant Voltage LED Driver

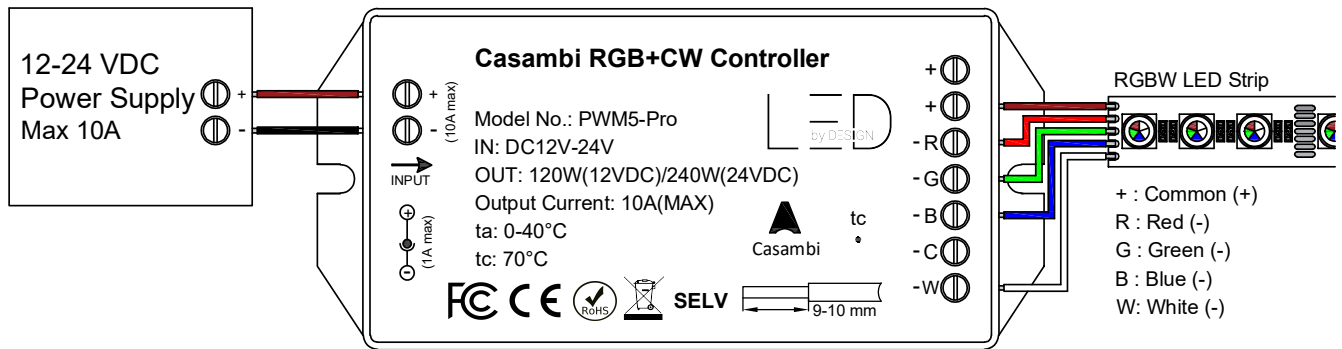

NOTES:

- Before setting up the device on the app, connect the LED strip and the power supply to the device. Then, turn on the power.
- Select a profile (1CH Dim, 2CH Dim, 3CH Dim, 4CH Dim, 5CH Dim, 1xTW, 2xTW, RGB, RGBW, RGBCW) before adding the device to the network ([see fig. 1](#)).

BASIC STEPS TO SET UP CASAMBI PWM5 Pro:

1. Download the CASAMBI APP

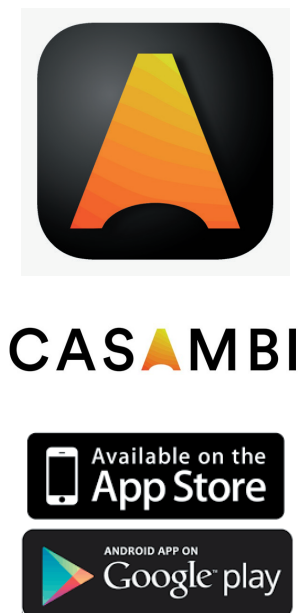

2. Create a New Network

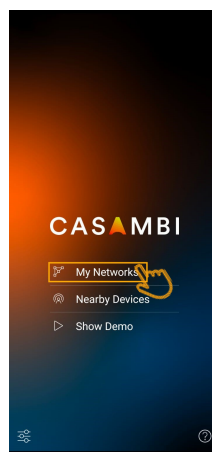

Open the app

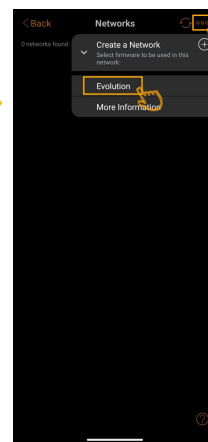

Create a Network

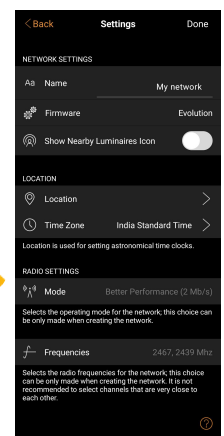

Assign a name to the new network e.g. "My network"

Item name	PWM5-Pro
Ordering code	LBD-PWM5PRO-CAS
Item code	LBD-PWM5PRO-CAS
Date	10-Jan-2025

BASIC STEPS TO SET UP CASAMBI PWM5 Pro:

3. Add the PWM5 Pro to the network



4. Control the paired Device

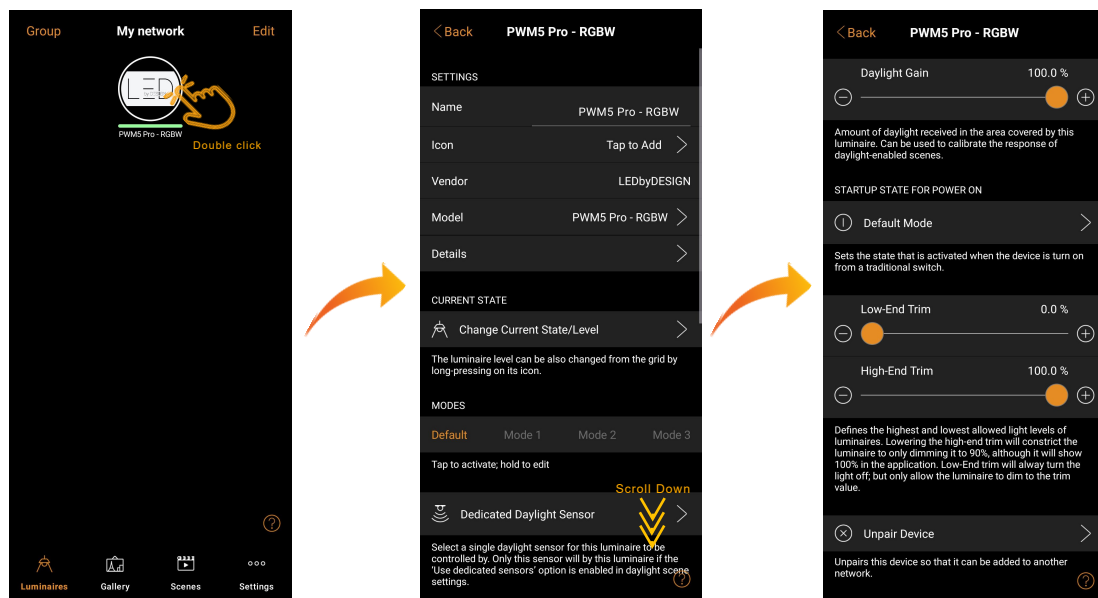

Item name	PWM5-Pro
Ordering code	LBD-PWM5PRO-CAS
Item code	LBD-PWM5PRO-CAS
Date	10-Jan-2025

BASIC STEPS TO SET UP CASAMBI PWM5 Pro:



ADDITIONAL NOTES:

- 1) The default profile is RGBTW*.
- 2) The interface will vary based on the selected profile**.
- 3) Colour picker is used for colour selection.
- 4) 10 Small boxes at the bottom are also scene selectors; select a colour that you like and then press and hold on a box, the colour is stored and appears in the box.